



PRODUCT CATALOGUE 2023

**INNOVATING BEYOND
PIONEERING AHEAD**

刀片系列 | 立铣刀系列 | 刀杆系列 | 走心机系列 | U钻系列

Insert series | End mill series | Holder serie | Precision automatic series | U drill series

-  86-0576-86970099
-  echo@wencerl.com
-  www.wencerl.com
-  Qianyangxia Village, Wenqiao Town, Wenling City, Zhejiang Province, the PRC



U钻 (U-Drill)

WC型浅孔钻/U钻 2D WC type U-drill 2D

钻削深度(Drilling depth): 2xD

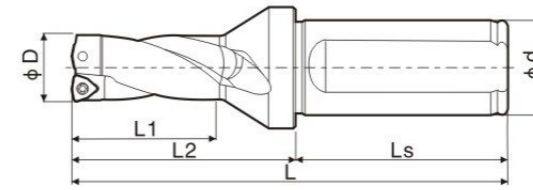

U钻系列
U drill series

规格型号 Specification and model	D	d	L1	Ls	L	刀片型号 Insert model	螺钉 Screw	扳手 Wrench	库存 Stock						
C20-2D15-33WC03	15	20	33	44	92	WC__030208	M2.5×5	T8							
C20-2D15.5-34WC03	15.5		34		93										
C20-2D16-35WC03	16		35		94										
C20-2D16.5-36WC03	16.5		36		95										
C20-2D17-37WC03	17		37		96										
C25-2D17.5-38WC03	17.5	25	38	56	109	WC__030208	M2.5×6	T8							
C25-2D18-39WC03	18		39		110										
C25-2D18.5-40WC03	18.5		40		111										
C25-2D19-41WC03	19		41		112										
C25-2D19.5-42WC03	19.5		42		113										
C25-2D20-43WC03	20		43		114										
C25-2D20.5-44WC03	20.5		44		115										
C25-2D21-45WC04	21	25	45	56	116	WC__040208	M2.5×7D	T8							
C25-2D21.5-46WC04	21.5		46		117										
C25-2D22-47WC04	22		47		118										
C25-2D22.5-48WC04	22.5		48		119										
C25-2D23-49WC04	23		49		123										
C25-2D23.5-50WC04	23.5		50		124										
C25-2D24-51WC04	24		51		125										
C25-2D24.5-52WC04	24.5		52		126										
C25-2D25-53WC05	25		53		127										
C32-2D25.5-54WC05	25.5		32		54					60	134	WC__050308	M3×7	T10	
C32-2D26-55WC05	26	55		135											
C32-2D26.5-56WC05	26.5	56		136											
C32-2D27-57WC05	27	57		137											
C32-2D27.5-58WC05	27.5	58		138											
C32-2D28-59WC05	28	59		139											
C32-2D28.5-60WC05	28.5	60		140											
C32-2D29-62WC05	29	62		143											
C32-2D29.5-63WC05	29.5	63		144											
C32-2D30-64WC05	30	64		148											
C32-2D30.5-65WC05	30.5	65		149											
C32-2D31-66WC06	31	32		66	60	150	WC__06T308	M3.5×8	T15						
C32-2D31.5-67WC06	31.5			67		151									
C32-2D32-68WC06	32		68	152											
C32-2D32.5-69WC06	32.5		69	153											
C32-2D33-70WC06	33		70	154											
C32-2D33.5-71WC06	33.5		71	155											

U钻 (U-Drill)

WC型浅孔钻/U钻 2D WC tyge U-drill 2D

钻削深度(Drilling depth): 2xD

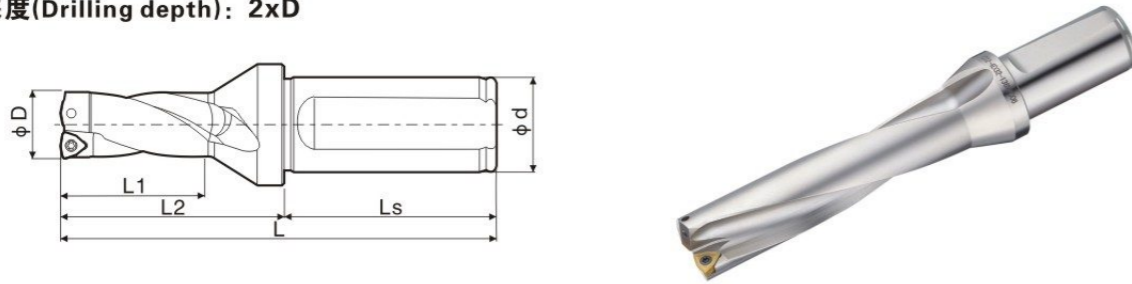

规格型号 Specification and model	D	d	L1	Ls	L	刀片型号 Insert model	螺钉 Screw	扳手 Wrench	库存 Stock
C32-2D34-72WC06	34	32	72	60	156	WC__06T308	M3.5×8	T15	
C32-2D34.5-73WC06	34.5		73		157				
C32-2D35-74WC06	35		74		158				
C32-2D35.5-75WC06	35.5		75		159				
C32-2D36-76WC06	36		76		160				
C32-2D36.5-77WC06	36.5		77		161				
C32-2D37-79WC06	37		79		169				
C32-2D37.5-80WC06	37.5		80		170				
C32-2D38-81WC06	38		81		171				
C32-2D38.5-82WC06	38.5		82		172				
C32-2D39-83WC06	39		83		173				
C32-2D39.5-84WC06	39.5		84		174				
C40-2D40-85WC06	40	40	85	70	185	WC__080412	M4×10	T15	
C40-2D41-87WC06	41		87		187				
C40-2D42-89WC08	42		89		189				
C40-2D43-91WC08	43		91		191				
C40-2D44-93WC08	44		93		193				
C40-2D45-95WC08	45		95		195				
C40-2D46-97WC08	46		97		197				
C40-2D47-99WC08	47		99		199				
C40-2D48-101WC08	48		101		201				
C40-2D49-103WC08	49		103		203				
C40-2D50-105WC08	50		105		205				
C40-2D51-107WC08	51		107		207				
C40-2D52-109WC08	52	109	209						
C40-2D53-111WC08	53	111	211						
C40-2D54-113WC08	54	113	213						
C40-2D55-115WC08	55	115	215						
C40-2D56-120WC08	56	120	222						
C40-2D57-122WC08	57	122	224						
C40-2D58-124WC08	58	124	226						
C40-2D59-126WC08	59	126	228						
C40-2D60-128WC08	60	128	230						

U钻 (U-Drill)

WC型浅孔钻/U钻 3D WC tyge U-drill 3D

钻削深度(Drilling depth): 3xD

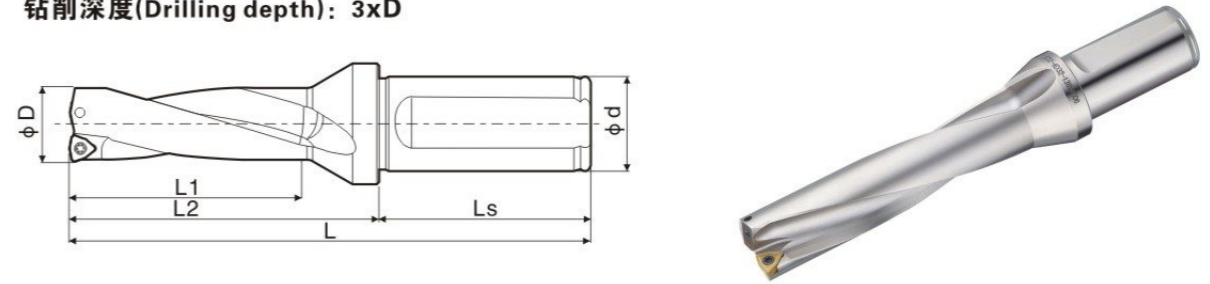

规格型号 Specification and model	D	d	L1	Ls	L	刀片型号 Insert model	螺钉 Screw	扳手 Wrench	库存 Stock
C20-3D15-48WC03	15	20	48	44	107	WC__030208	M2.5×5	T8	
C20-3D15.5-50WC03	15.5		50		109				
C20-3D16-51WC03	16		51		110				
C20-3D16.5-53WC03	16.5		53		112				
C20-3D17-54WC03	17		54		113				
C25-3D17.5-56WC03	17.5		56		127				
C25-3D18-57WC03	18	25	57	56	128	WC__030208	M2.5×6	T8	
C25-3D18.5-59WC03	18.5		59		130				
C25-3D19-60WC03	19		60		131				
C25-3D19.5-62WC03	19.5		62		133				
C25-3D20-63WC03	20		63		134				
C25-3D20.5-65WC03	20.5		65		136				
C25-3D21-66WC04	21		66		137				
C25-3D21.5-68WC04	21.5		68		139				
C25-3D22-69WC04	22		69		140				
C25-3D22.5-71WC04	22.5		71		142				
C25-3D23-72WC04	23		72		146				
C25-3D23.5-74WC04	23.5		74		148				
C25-3D24-75WC04	24	75	149						
C25-3D24.5-77WC04	24.5	77	151						
C25-3D25-78WC05	25	78	152						
C32-3D25.5-80WC05	25.5	32	80	60	160	WC__050308	M3×7	T10	
C32-3D26-81WC05	26		81		161				
C32-3D26.5-83WC05	26.5		83		163				
C32-3D27-84WC05	27		84		164				
C32-3D27.5-86WC05	27.5		86		166				
C32-3D28-87WC05	28		87		167				
C32-3D28.5-89WC05	28.5		89		169				
C32-3D29-91WC05	29		91		172				
C32-3D29.5-93WC05	29.5		93		174				
C32-3D30-94WC05	30		94		178				
C32-3D30.5-96WC05	30.5		96		180				
C32-3D31-97WC06	31		97		181				
C32-3D31.5-99WC06	31.5	99	183						
C32-3D32-100WC06	32	100	184						
C32-3D32.5-102WC06	32.5	102	186						
C32-3D33-103WC06	33	103	187						
C32-3D33.5-105WC06	33.5	105	189						
C32-3D31-97WC06	31	32	97	60	181	WC__06T308	M3.5×8	T15	
C32-3D31.5-99WC06	31.5		99		183				
C32-3D32-100WC06	32		100		184				
C32-3D32.5-102WC06	32.5		102		186				
C32-3D33-103WC06	33		103		187				
C32-3D33.5-105WC06	33.5		105		189				

U钻 (U-Drill)

WC型浅孔钻/U钻 3D WC tyge U-drill 3D

钻削深度(Drilling depth): 3xD

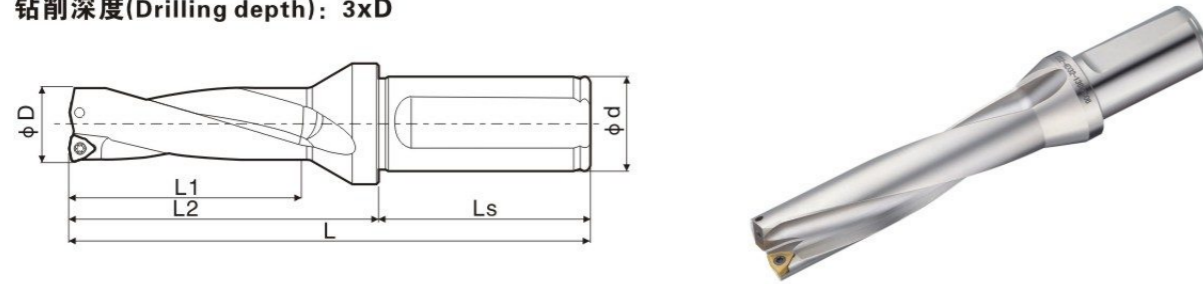

规格型号 Specification and model	D	d	L1	Ls	L	刀片型号 Insert model	螺钉 Screw	扳手 Wrench	库存 Stock						
C32-3D34-106WC06	34	32	106	60	190	WC__06T308	M3.5×8	T15							
C32-3D34.5-108WC06	34.5		108		192										
C32-3D35-109WC06	35		109		193										
C32-3D35.5-111WC06	35.5		111		195										
C32-3D36-112WC06	36		112		196										
C32-3D36.5-114WC06	36.5		114		198										
C32-3D37-116WC06	37		116		206										
C32-3D37.5-118WC06	37.5		118		208										
C32-3D38-119WC06	38		119		209										
C32-3D38.5-121WC06	38.5		121		211										
C32-3D39-122WC06	39		122		212										
C32-3D39.5-124WC06	39.5		124		214										
C40-3D40-125WC06	40		40		125					70	225	WC__080412	M4×10	T15	
C40-3D41-128WC06	41				128						228				
C40-3D42-131WC08	42	131		231											
C40-3D43-134WC08	43	134		234											
C40-3D44-137WC08	44	137		237											
C40-3D45-140WC08	45	140		240											
C40-3D46-143WC08	46	143		243											
C40-3D47-146WC08	47	146		246											
C40-3D48-149WC08	48	149		249											
C40-3D49-152WC08	49	152		252											
C40-3D50-155WC08	50	155		255											
C40-3D51-158WC08	51	158		258											
C40-3D52-161WC08	52	161		261											
C40-3D53-164WC08	53	164		264											
C40-3D54-167WC08	54	167		267											
C40-3D55-170WC08	55	170		270											
C40-3D56-176WC08	56	176		278											
C40-3D57-179WC08	57	179		281											
C40-3D58-182WC08	58	182	284												
C40-3D59-185WC08	59	185	287												
C40-3D60-188WC08	60	188	290												

U钻 (U-Drill)

WC型浅孔钻/U钻 4D WC tyge U-drill 4D

钻削深度(Drilling depth): 4xD

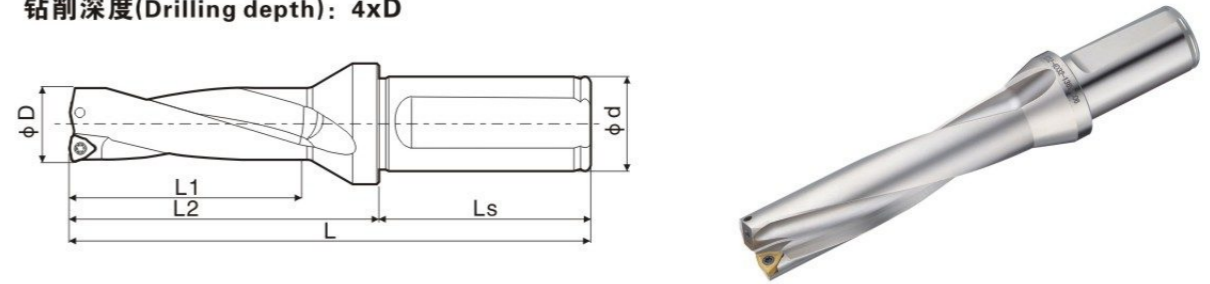

规格型号 Specification and model	D	d	L1	Ls	L	刀片型号 Insert model	螺钉 Screw	扳手 Wrench	库存 Stock
C20-4D15-63WC03	15	20	63	44	122	WC__030208	M2.5×5	T8	
C20-4D15.5-65WC03	15.5		65		124				
C20-4D16-67WC03	16		67		126				
C20-4D16.5-69WC03	16.5		69		128				
C20-4D17-71WC03	17		71		130				
C25-4D17.5-73WC03	17.5		73		144				
C25-4D18-75WC03	18	75	146						
C25-4D18.5-77WC03	18.5	77	148						
C25-4D19-79WC03	19	25	79	56	150	WC__030208	M2.5×6	T8	
C25-4D19.5-81WC03	19.5	81	152						
C25-4D20-83WC03	20	83	154						
C25-4D20.5-85WC03	20.5	85	156						
C25-4D21-87WC04	21	87	158						
C25-4D21.5-89WC04	21.5	89	160						
C25-4D22-91WC04	22	91	162						
C25-4D22.5-93WC04	22.5	93	164						
C25-4D23-95WC04	23	25	95	56	169	WC__040208	M2.5×7D	T8	
C25-4D23.5-97WC04	23.5	97	171						
C25-4D24-99WC04	24	99	173						
C25-4D24.5-101WC04	24.5	101	175						
C25-4D25-103WC05	25	103	177						
C32-4D25.5-105WC05	25.5	105	185						
C32-4D26-107WC05	26	107	187						
C32-4D26.5-109WC05	26.5	109	189						
C32-4D27-111WC05	27	111	191						
C32-4D27.5-113WC05	27.5	113	193						
C32-4D28-115WC05	28	32	115	60	195	WC__050308	M3×7	T10	
C32-4D28.5-117WC05	28.5	117	197						
C32-4D29-120WC05	29	120	201						
C32-4D29.5-122WC05	29.5	122	203						
C32-4D30-124WC05	30	124	208						
C32-4D30.5-126WC05	30.5	126	210						
C32-4D31-128WC06	31	128	212						
C32-4D31.5-130WC06	31.5	130	214						
C32-4D32-132WC06	32	32	132	60	216	WC__06T308	M3.5×8	T15	
C32-4D32.5-134WC06	32.5	134	218						
C32-4D33-136WC06	33	136	220						
C32-4D33.5-138WC06	33.5	138	222						

U钻 (U-Drill)

WC型浅孔钻/U钻 4D WC tyge U-drill 4D

钻削深度(Drilling depth): 4xD

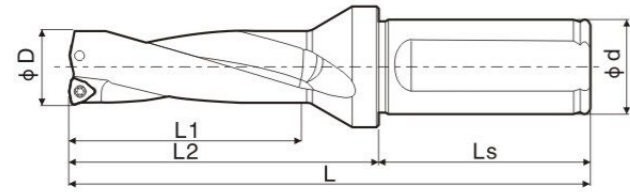

规格型号 Specification and model	D	d	L1	Ls	L	刀片型号 Insert model	螺钉 Screw	扳手 Wrench	库存 Stock						
C32-4D34-140WC06	34	32	140	60	224	WC__06T308	M3.5×8	T15							
C32-4D34.5-142WC06	34.5		142		226										
C32-4D35-144WC06	35		144		228										
C32-4D35.5-146WC06	35.5		146		230										
C32-4D36-148WC06	36		148		232										
C32-4D36.5-150WC06	36.5		150		236										
C32-4D37-153WC06	37		153		243										
C32-4D37.5-155WC06	37.5		155		245										
C32-4D38-157WC06	38		157		247										
C32-4D38.5-159WC06	38.5		159		249										
C32-4D39-161WC06	39		161		251										
C32-4D39.5-163WC06	39.5		163		253										
C40-4D40-165WC06	40		40		165					70	265	WC__080412	M4×10	T15	
C40-4D41-169WC06	41				169						269				
C40-4D42-173WC08	42	173		273											
C40-4D43-177WC08	43	177		277											
C40-4D44-181WC08	44	181		281											
C40-4D45-185WC08	45	185		285											
C40-4D46-189WC08	46	189		289											
C40-4D47-193WC08	47	193		293											
C40-4D48-197WC08	48	197		297											
C40-4D49-201WC08	49	201		301											
C40-4D50-205WC08	50	205		305											
C40-4D51-209WC08	51	209		309											
C40-4D52-213WC08	52	213		313											
C40-4D53-217WC08	53	217		317											
C40-4D54-221WC08	54	221		321											
C40-4D55-225WC08	55	225		325											
C40-4D56-232WC08	56	232	334												
C40-4D57-236WC08	57	236	338												
C40-4D58-240WC08	58	240	342												
C40-4D59-244WC08	59	244	346												
C40-4D60-248WC08	60	248	350												

U钻 (U-Drill)

WC型浅孔钻/U钻 5D WC tyge U-drill 5D

钻削深度(Drilling depth): 5xD

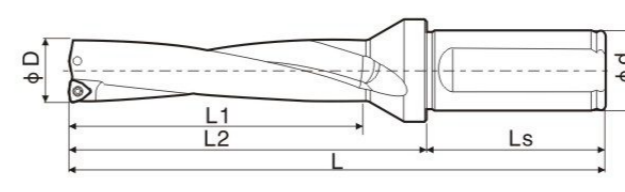

规格型号 Specification and model	D	d	L1	Ls	L	刀片型号 Insert model	螺钉 Screw	扳手 Wrench	库存 Stock
C20-5D16-83WC03	16	20	83	44	142	WC__030208	M2.5×5	T8	
C20-5D16.5-86WC03	16.5		86		145				
C20-5D17-88WC03	17		88		147				
C25-5D17.5-91WC03	17.5	25	91	56	150	WC__030208	M2.5×6	T8	
C25-5D18-93WC03	18		93		152				
C25-5D18.5-96WC03	18.5		96		155				
C25-5D19-98WC03	19		98		157				
C25-5D19.5-101WC03	19.5		101		160				
C25-5D20-103WC03	20		103		162				
C25-5D20.5-106WC03	20.5		106		165				
C25-5D21-108WC04	21	25	108	56	167	WC__040208	M2.5×7D	T8	
C25-5D21.5-111WC04	21.5		111		170				
C25-5D22-113WC04	22		113		172				
C25-5D22.5-116WC04	22.5		116		175				
C25-5D23-118WC04	23		118		180				
C25-5D23.5-121WC04	23.5		121		183				
C25-5D24-123WC04	24		123		185				
C25-5D24.5-126WC04	24.5		126		188				
C25-5D25-128WC05	25		128		190				
C32-5D25.5-131WC05	25.5		32		131				
C32-5D26-133WC05	26	133		216					
C32-5D26.5-136WC05	26.5	136		217					
C32-5D27-138WC05	27	138		218					
C32-5D27.5-141WC05	27.5	141		221					
C32-5D28-143WC05	28	143		223					
C32-5D28.5-146WC05	28.5	146		226					
C32-5D29-149WC05	29	149		230					
C32-5D29.5-151WC05	29.5	151		233					
C32-5D30-154WC05	30	154		238					
C32-5D30.5-157WC05	30.5	157		241					
C32-5D31-159WC06	31	32		159	60	243	WC__06T308	M3.5×8	T15
C32-5D31.5-162WC06	31.5		162	245					
C32-5D32-164WC06	32		164	248					
C32-5D32.5-167WC06	32.5		167	251					
C32-5D33-169WC06	33		169	253					
C32-5D33.5-172WC06	33.5		172	255					
C32-5D34-174WC06	34		174	258					

U钻 (U-Drill)

WC型浅孔钻/U钻 5D WC tyge U-drill 5D

钻削深度(Drilling depth): 5xD

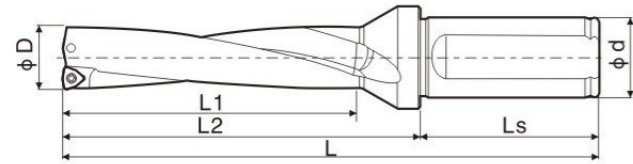

规格型号 Specification and model	D	d	L1	Ls	L	刀片型号 Insert model	螺钉 Screw	扳手 Wrench	库存 Stock
C32-5D34.5-177WC06	34.5	32	177	60	261	WC__06T308	M3.5×8	T15	
C32-5D35-179WC06	35		179		263				
C32-5D35.5-182WC06	35.5		182		265				
C32-5D36-184WC06	36		184		268				
C32-5D36.5-187WC06	36.5		187		271				
C32-5D37-190WC06	37		190		280				
C32-5D37.5-193WC06	37.5		193		283				
C32-5D38-195WC06	38		195		285				
C32-5D38.5-198WC06	38.5		198		288				
C32-5D39-200WC06	39		200		290				
C32-5D39.5-203WC06	39.5		203		293				
C40-5D40-205WC06	40		40		205				
C40-5D41-210WC06	41	210		310					
C40-5D42-220WC08	42	220		315					
C40-5D43-225WC08	43	225		320					
C40-5D44-230WC08	44	230		325					
C40-5D45-235WC08	45	235		330					
C40-5D46-240WC08	46	240		335					
C40-5D47-245WC08	47	245		340					
C40-5D48-250WC08	48	250		345					
C40-5D49-255WC08	49	255		350					
C40-5D50-260WC08	50	260		355					
C40-5D51-265WC08	51	265		360					
C40-5D52-270WC08	52	270	365						
C40-5D53-275WC08	53	275	370						
C40-5D54-280WC08	54	280	375						
C40-5D55-285WC08	55	285	380						
C40-5D56-290WC08	56	290	385						
C40-5D57-295WC08	57	295	390						
C40-5D58-300WC08	58	300	395						
C40-5D59-305WC08	59	305	400						
C40-5D60-310WC08	60	310	405						

U钻 (U-Drill)

SP型浅孔钻/U钻 2D SP tyge U-drill 2D

钻削深度(Drilling depth): 2xD

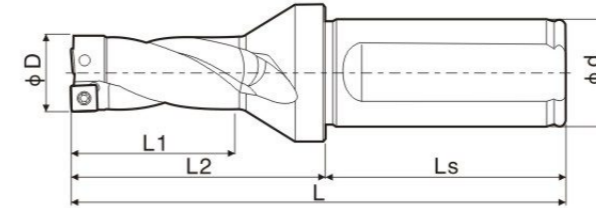

规格型号 Specification and model	D	d	L1	Ls	L	刀片型号 Insert model	螺钉 Screw	扳手 Wrench	库存 Stock
C20-2D13-29SP05	13	20	29	44	88	SP__050204	M2×4	T6	
C20-2D13.5-30SP05	13.5		30		89				
C20-2D14-31SP05	14		31		90				
C20-2D14.5-32SP05	14.5		32		91				
C20-2D15-33SP05	15		33		92				
C20-2D15.5-34SP06	15.5	25	34	44	93	SP__060204	M2.2×5	T7	
C20-2D16-35SP06	16		35		94				
C20-2D16.5-36SP06	16.5		36		95				
C20-2D17-37SP06	17		37		96				
C25-2D17.5-38SP06	17.5		38		109				
C25-2D18-39SP06	18	39	110						
C25-2D18.5-40SP06	18.5	40	111						
C25-2D19-41SP06	19	41	112						
C25-2D19.5-42SP06	19.5	25	42	56	113	SP__07T308	M2.5×6	T8	
C25-2D20-43SP06	20		43		114				
C25-2D20.5-44SP06	20.5		44		115				
C25-2D21-45SP06	21		45		116				
C25-2D21.5-46SP06	21.5		46		117				
C25-2D22-47SP07	22	25	47	56	118	SP__090408	M3.5×8	T15	
C25-2D22.5-48SP07	22.5		48		119				
C25-2D23-49SP07	23		49		123				
C25-2D23.5-50SP07	23.5		50		124				
C25-2D24-51SP07	24		51		125				
C25-2D24.5-52SP07	24.5	52	126						
C25-2D25-53SP07	25	53	127						
C32-2D25.5-54SP07	25.5	32	54	60	134	SP__090408	M3.5×8	T15	
C32-2D26-55SP07	26		55		135				
C32-2D26.5-56SP07	26.5		56		136				
C32-2D27-57SP07	27		57		137				
C32-2D27.5-58SP07	27.5		58		138				
C32-2D28-59SP09	28	32	59	60	139	SP__090408	M3.5×8	T15	
C32-2D28.5-60SP09	28.5		60		140				
C32-2D29-62SP09	29		62		143				
C32-2D29.5-63SP09	29.5		63		144				
C32-2D30-64SP09	30		64		148				
C32-2D30.5-65SP09	30.5	65	149						
C32-2D31-66SP09	31	66	150						
C32-2D31.5-67SP09	31.5	67	151						

U钻 (U-Drill)

SP型浅孔钻/U钻 2D SP tyge U-drill 2D

钻削深度(Drilling depth): 2xD

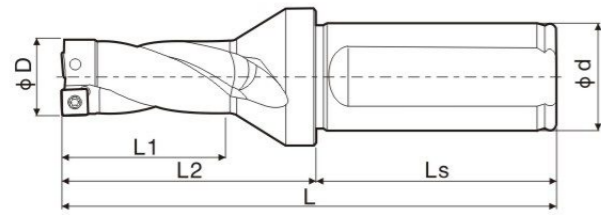

规格型号 Specification and model	D	d	L1	Ls	L	刀片型号 Insert model	螺钉 Screw	扳手 Wrench	库存 Stock						
C32-2D32-68SP09	32	32	68	60	152	SP__090408	M3.5×8	T15							
C32-2D32.5-69SP09	32.5		69		153										
C32-2D33-70SP09	33		70		154										
C32-2D33.5-71SP09	33.5		71		155										
C32-2D34-72SP11	34	32	72	60	156	SP__110408	M4×10	T15							
C32-2D34.5-73SP11	34.5		73		157										
C32-2D35-74SP11	35		74		158										
C32-2D35.5-75SP11	35.5		75		159										
C32-2D36-76SP11	36		76		160										
C32-2D36.5-77SP11	36.5		77		161										
C32-2D37-79SP11	37		79		169										
C32-2D37.5-80SP11	37.5		80		170										
C32-2D38-81SP11	38		81		171										
C32-2D38.5-82SP11	38.5		82		172										
C32-2D39-83SP11	39		83		173										
C32-2D39.5-84SP11	39.5		84		174										
C40-2D40-85SP11	40		40		85					70	185	SP__140512	M5×11	T20	
C40-2D41-87SP11	41				87						187				
C40-2D42-89SP14	42				89						189				
C40-2D43-91SP14	43				91						191				
C40-2D44-93SP14	44	93		193											
C40-2D45-95SP14	45	95		195											
C40-2D46-97SP14	46	97		197											
C40-2D47-99SP14	47	99		199											
C40-2D48-101SP14	48	101		201											
C40-2D49-103SP14	49	103		203											
C40-2D50-105SP14	50	105		205											
C40-2D51-107SP09	51	107		207											
C40-2D52-109SP09	52	109		209											
C40-2D53-111SP09	53	111		211											
C40-2D54-113SP09	54	113		213											
C40-2D55-115SP09	55	115		215											
C40-2D56-120SP09	56	120	222												
C40-2D57-122SP09	57	122	224												
C40-2D58-124SP09	58	124	226												
C40-2D59-126SP09	59	126	228												
C40-2D60-128SP09	60	128	230												
C40-2D51-107SP09	51	40	107	70	207	SP__090408	M3.5×8	T15							
C40-2D52-109SP09	52		109		209										
C40-2D53-111SP09	53		111		211										
C40-2D54-113SP09	54		113		213										
C40-2D55-115SP09	55		115		215										
C40-2D56-120SP09	56		120		222										
C40-2D57-122SP09	57		122		224										
C40-2D58-124SP09	58		124		226										
C40-2D59-126SP09	59		126		228										
C40-2D60-128SP09	60		128		230										

U钻 (U-Drill)

SP型浅孔钻/U钻 3D SP tyge U-drill 3D

钻削深度(Drilling depth): 3xD

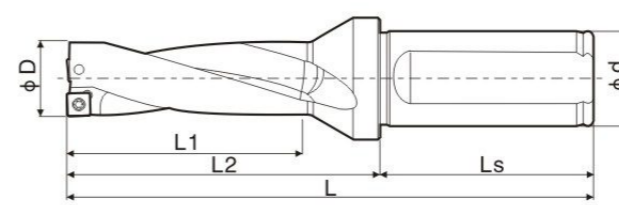

规格型号 Specification and model	D	d	L1	Ls	L	刀片型号 Insert model	螺钉 Screw	扳手 Wrench	库存 Stock
C20-3D13-42SP05	13	20	42	44	101	SP__050204	M2×4	T6	
C20-3D13.5-44SP05	13.5		44		103				
C20-3D14-45SP05	14		45		104				
C20-3D14.5-47SP05	14.5		47		106				
C20-3D15-48SP05	15	25	48	44	107	SP__060204	M2.2×5	T7	
C20-3D15.5-50SP06	15.5		50		109				
C20-3D16-51SP06	16		51		110				
C20-3D16.5-53SP06	16.5		53		112				
C20-3D17-54SP06	17		54		113				
C25-3D17.5-56SP06	17.5		56		127				
C25-3D18-57SP06	18		57		128				
C25-3D18.5-59SP06	18.5		59		130				
C25-3D19-60SP06	19	25	60	56	131	SP__07T308	M2.5×6	T8	
C25-3D19.5-62SP06	19.5		62		133				
C25-3D20-63SP06	20		63		134				
C25-3D20.5-65SP06	20.5		65		136				
C25-3D21-66SP06	21		66		137				
C25-3D21.5-68SP06	21.5		68		139				
C25-3D22-69SP07	22		69		140				
C25-3D22.5-71SP07	22.5		71		142				
C25-3D23-72SP07	23		72		146				
C25-3D23.5-74SP07	23.5		74		148				
C25-3D24-75SP07	24		75		149				
C25-3D24.5-77SP07	24.5		77		151				
C25-3D25-78SP07	25		78		152				
C32-3D25.5-80SP07	25.5		80		160				
C32-3D26-81SP07	26		81		161				
C32-3D26.5-83SP07	26.5		32		83				
C32-3D27-84SP07	27	84		164					
C32-3D27.5-86SP07	27.5	86		166					
C32-3D28-87SP09	28	87		167					
C32-3D28.5-89SP09	28.5	32	89	60	169	SP__090408	M3.5×8	T15	
C32-3D29-91SP09	29		91		172				
C32-3D29.5-93SP09	29.5		93		174				
C32-3D30-94SP09	30		94		178				
C32-3D30.5-96SP09	30.5		96		180				
C32-3D31-97SP09	31		97		181				
C32-3D31.5-99SP09	31.5		99		183				

U钻 (U-Drill)

SP型浅孔钻/U钻 3D SP tyge U-drill 3D

钻削深度(Drilling depth): 3xD

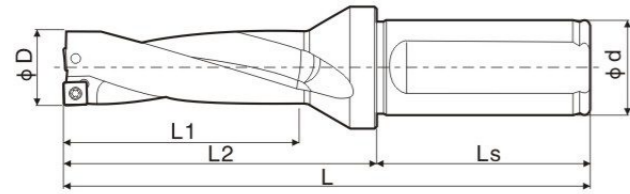

规格型号 Specification and model	D	d	L1	Ls	L	刀片型号 Insert model	螺钉 Screw	扳手 Wrench	库存 Stock
C32-3D32-100SP09	32	32	100	60	184	SP__090408	M3.5×8	T15	
C32-3D32.5-102SP09	32.5		102		186				
C32-3D33-103SP09	33		103		187				
C32-3D33.5-105SP09	33.5		105		189				
C32-3D34-106SP11	34	32	106	60	190	SP__110408	M4×10	T15	
C32-3D34.5-108SP11	34.5		108		192				
C32-3D35-109SP11	35		109		193				
C32-3D35.5-111SP11	35.5		111		195				
C32-3D36-112SP11	36		112		196				
C32-3D36.5-114SP11	36.5		114		198				
C32-3D37-116SP11	37		116		206				
C32-3D37.5-118SP11	37.5		118		207				
C32-3D38-119SP11	38		119		209				
C32-3D38.5-121SP11	38.5		121		211				
C32-3D39-122SP11	39		122		212				
C32-3D39.5-124SP11	39.5		124		214				
C40-3D40-125SP11	40	40	125	70	225	SP__140512	M5×11	T20	
C40-3D41-128SP11	41		128		228				
C40-3D42-131SP14	42		131		231				
C40-3D43-134SP14	43		134		234				
C40-3D44-137SP14	44		137		237				
C40-3D45-140SP14	45		140		240				
C40-3D46-143SP14	46		143		243				
C40-3D47-146SP14	47		146		246				
C40-3D48-149SP14	48		149		249				
C40-3D49-152SP14	49		152		252				
C40-3D50-155SP14	50		155		255				
C40-3D51-158SP09	51		40		158				
C40-3D52-161SP09	52	161		261					
C40-3D53-164SP09	53	164		264					
C40-3D54-167SP09	54	167		267					
C40-3D55-170SP09	55	170		270					
C40-3D56-173SP09	56	176		278					
C40-3D57-179SP09	57	179		281					
C40-3D58-182SP09	58	182		284					
C40-3D59-185SP09	59	185		287					
C40-3D60-188SP09	60	188		290					

U钻 (U-Drill)

SP型浅孔钻/U钻 4D SP tyge U-drill 4D

钻削深度(Drilling depth): 4xD

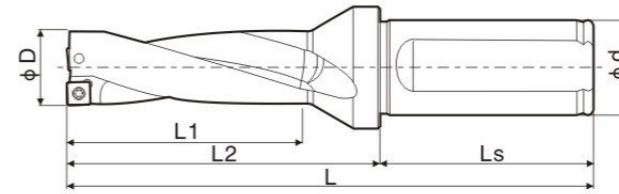

规格型号 Specification and model	D	d	L1	Ls	L	刀片型号 Insert model	螺钉 Screw	扳手 Wrench	库存 Stock
C20-4D13-55SP05	13	20	55	44	114	SP__050204	M2×4	T6	
C20-4D13.5-57SP05	13.5		57		116				
C20-4D14-59SP05	14		59		118				
C20-4D14.5-61SP05	14.5		61		120				
C20-4D15-63SP05	15		63		122				
C20-4D15.5-65SP06	15.5	25	65	44	124	SP__060204	M2.2×5	T7	
C20-4D16-67SP06	16		67		126				
C20-4D16.5-69SP06	16.5		69		128				
C20-4D17-71SP06	17		71		130				
C25-4D17.5-73SP06	17.5		73		144				
C25-4D18-75SP06	18	25	75	56	146	SP__07T308	M2.5×6	T8	
C25-4D18.5-77SP06	18.5		77		148				
C25-4D19-79SP06	19		79		150				
C25-4D19.5-81SP06	19.5		81		152				
C25-4D20-83SP06	20		83		154				
C25-4D20.5-85SP06	20.5	32	85	60	156	SP__090408	M3.5×8	T15	
C25-4D21-87SP06	21		87		158				
C25-4D21.5-89SP06	21.5		89		160				
C25-4D22-91SP07	22		91		162				
C25-4D22.5-93SP07	22.5		93		164				
C25-4D23-95SP07	23	32	95	60	169	SP__090408	M3.5×8	T15	
C25-4D23.5-97SP07	23.5		97		171				
C25-4D24-99SP07	24		99		173				
C25-4D24.5-101SP07	24.5		101		175				
C25-4D25-103SP07	25		103		177				
C32-4D25.5-105SP07	25.5	32	105	60	185	SP__090408	M3.5×8	T15	
C32-4D26-107SP07	26		107		187				
C32-4D26.5-109SP07	26.5		109		189				
C32-4D27-111SP07	27		111		191				
C32-4D27.5-113SP07	27.5		113		193				
C32-4D28-115SP09	28	32	115	60	195	SP__090408	M3.5×8	T15	
C32-4D28.5-117SP09	28.5		117		197				
C32-4D29-120SP09	29		120		201				
C32-4D29.5-122SP09	29.5		122		203				
C32-4D30-124SP09	30		124		208				
C32-4D30.5-126SP09	30.5	32	126	60	210	SP__090408	M3.5×8	T15	
C32-4D31-128SP09	31		128		212				
C32-4D31.5-130SP09	31.5		130		214				

U钻 (U-Drill)

SP型浅孔钻/U钻 4D SP tyge U-drill 4D

钻削深度(Drilling depth): 4xD

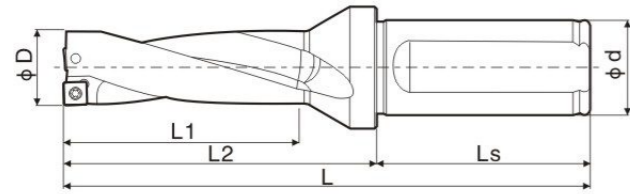

规格型号 Specification and model	D	d	L1	Ls	L	刀片型号 Insert model	螺钉 Screw	扳手 Wrench	库存 Stock
C32-4D32-132SP09	32	32	132	60	216	SP__090408	M3.5×8	T15	
C32-4D32.5-134SP09	32.5		134		218				
C32-4D33-136SP09	33		136		220				
C32-4D33.5-138SP09	33.5		138		222				
C32-4D34-140SP11	34	32	140	60	224	SP__110408	M4×10	T15	
C32-4D34.5-142SP11	34.5		142		226				
C32-4D35-144SP11	35		144		228				
C32-4D35.5-146SP11	35.5		146		230				
C32-4D36-148SP11	36		148		232				
C32-4D36.5-150SP11	36.5		150		234				
C32-4D37-152SP11	37		153		243				
C32-4D37.5-155SP11	37.5		155		245				
C32-4D38-157SP11	38		157		247				
C32-4D38.5-159SP11	38.5		159		249				
C32-4D39-161SP11	39		161		251				
C32-4D39.5-163SP11	39.5		163		253				
C40-4D40-165SP11	40	40	165	70	265	SP__140512	M5×11	T20	
C40-4D41-169SP11	41		169		269				
C40-4D42-173SP14	42		173		273				
C40-4D43-177SP14	43		177		277				
C40-4D44-181SP14	44		181		281				
C40-4D45-185SP14	45		185		285				
C40-4D46-189SP14	46		189		289				
C40-4D47-193SP14	47		193		293				
C40-4D48-197SP14	48		197		297				
C40-4D49-201SP14	49		201		301				
C40-4D50-205SP14	50		205		305				
C40-4D51-209SP09	51		40		209				
C40-4D52-213SP09	52	213		313					
C40-4D53-217SP09	53	217		317					
C40-4D54-221SP09	54	221		321					
C40-4D55-225SP09	55	225		325					
C40-4D56-232SP09	56	232		334					
C40-4D57-236SP09	57	236		338					
C40-4D58-240SP09	58	240		342					
C40-4D59-244SP09	59	244		346					
C40-4D60-248SP09	60	248		350					

U钻 (U-Drill)

SP型浅孔钻/U钻 5D SP tyge U-drill 5D

钻削深度(Drilling depth): 5xD

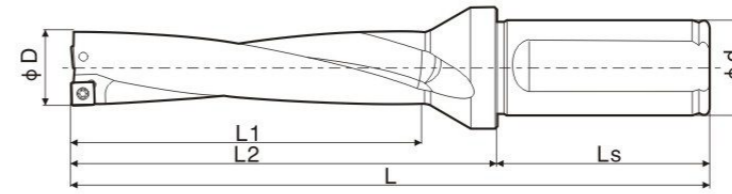

规格型号 Specification and model	D	d	L1	Ls	L	刀片型号 Insert model	螺钉 Screw	扳手 Wrench	库存 Stock						
C20-5D16-83SP06	16	20	83	44	142	SP__060204	M2.2×5	T7							
C20-5D16.5-86SP06	16.5		86		145										
C20-5D17-88SP06	17		88		147										
C20-5D17.5-91SP06	17.5		91		162										
C25-5D18-939SP06	18	25	93	56	164					SP__07T308	M2.5×6	T8			
C25-5D18.5-96SP06	18.5		96		167										
C25-5D19-98SP06	19		98		169										
C25-5D19.5-101SP06	19.5		101		172										
C25-5D20-103SP06	20		103		174										
C25-5D20.5-106SP06	20.5		106		177										
C25-5D21-108SP06	21		108		179										
C25-5D21.5-111SP06	21.5		111		182										
C25-5D22-113SP07	22		113		184										
C25-5D22.5-116SP07	22.5		116		187										
C25-5D23-118SP07	23		118		192										
C25-5D23.5-121SP07	23.5		121		195										
C25-5D24-123SP07	24	123	197												
C25-5D24.5-126SP07	24.5	126	200												
C25-5D25-128SP07	25	128	202												
C32-5D25.5-130SP07	25.5	32	130	60	213	SP__090408	M3.5×8	T15							
C32-5D26-133SP07	26		133		216										
C32-5D26.5-136SP07	26.5		136		218										
C32-5D27-138SP07	27		138		219										
C32-5D27.5-141SP07	27.5		141		221										
C32-5D28-143SP09	28		32		143					60	223	SP__090408	M3.5×8	T15	
C32-5D28.5-146SP09	28.5				146						226				
C32-5D29-149SP09	29				149						230				
C32-5D29.5-151SP09	29.5				151						233				
C32-5D30-154SP09	30				154						238				
C32-5D30.5-157SP09	30.5				157						241				
C32-5D31-159SP09	31				159						243				
C32-5D31.5-162SP09	31.5	162		245											
C32-5D32-164SP09	32	32		164	60	248	SP__090408	M3.5×8	T15						
C32-5D32.5-167SP09	32.5			167		251									
C32-5D33-169SP09	33			169		253									
C32-5D33.5-172SP09	33.5			172		255									

U钻 (U-Drill)

SP型浅孔钻/U钻 5D SP tyge U-drill 5D

钻削深度(Drilling depth): 5xD

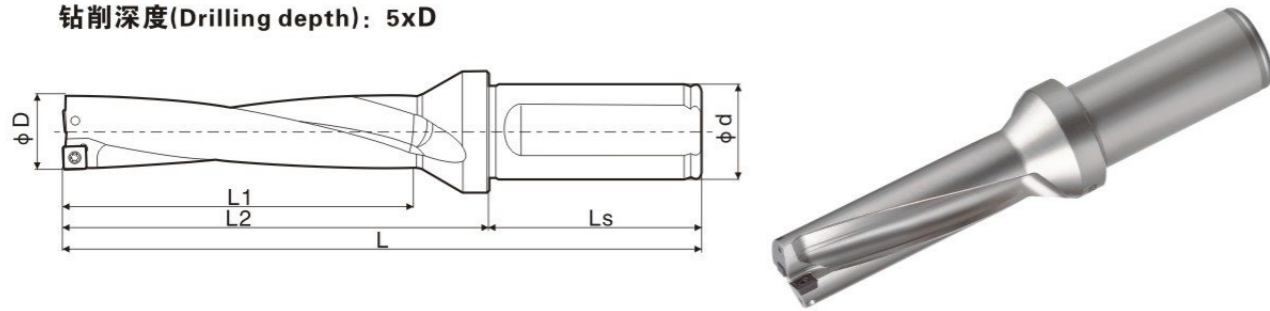

规格型号 Specification and model	D	d	L1	Ls	L	刀片型号 Insert model	螺钉 Screw	扳手 Wrench	库存 Stock
C32-5D34-174SP11	34	32	174	60	258	SP__110408	M4×10	T15	
C32-5D34.5-177SP11	34.5		177		261				
C32-5D35-179SP11	35		179		263				
C32-5D35.5-182SP11	35.5		182		265				
C32-5D36-184SP11	36		184		268				
C32-5D36.5-187SP11	36.5		187		271				
C32-5D37-190SP11	37		190		280				
C32-5D37.5-193SP11	37.5		193		283				
C32-5D38-195SP11	38		195		285				
C32-5D38.5-198SP11	38.5		198		288				
C32-5D39-200SP11	39		200		290				
C32-5D39.5-203SP11	39.5		203		293				
C40-5D40-205SP11	40	40	205	70	305	SP__140512	M5×11	T20	
C40-5D41-210SP11	41		210		310				
C40-5D42-215SP14	42		215		315				
C40-5D43-220SP14	43		220		320				
C40-5D44-225SP14	44		225		325				
C40-5D45-230SP14	45		230		330				
C40-5D46-235SP14	46		235		335				
C40-5D47-240SP14	47		240		340				
C40-5D48-245SP14	48		245		345				
C40-5D49-250SP14	49		250		350				
C40-5D50-255SP14	50		255		355				
C40-5D51-260SP09	51		40		260				
C40-5D52-265SP09	52	265		365					
C40-5D53-270SP09	53	270		370					
C40-5D54-275SP09	54	275		375					
C40-5D55-280SP09	55	280		380					
C40-5D56-285SP09	56	285		385					
C40-5D57-290SP09	57	290		390					
C40-5D58-295SP09	58	295		395					
C40-5D59-300SP09	59	300		400					
C40-5D60-305SP09	60	305		405					

U钻 (U-Drill)

多功能刀杆 浅孔钻/U钻 2.25D Multi fanchon U-drill 2.25D

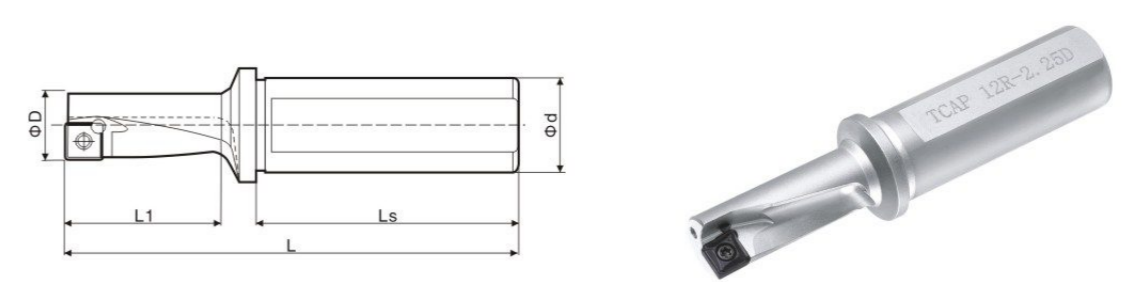

规格型号 Specification and model	D	d	L1	Ls	L	刀片型号 Insert model	螺钉 Screw	扳手 Wrench	库存 Stock	
TCAP 08R/L-2.25DN	8	12	18	42	66	XCMT040104	M1.8*4	T6		
TCAP 10R/L-2.25DN	10		22.5		70	XCMT050204	M2.0*5			
TCAP 12R/L-2.25DN	12	16	27	45	78	XCMT060204	M2.2*5			
TCAP 14R/L-2.25DN	14		31.5		82	XCMT070304	M2.5*6			
TCAP 16R/L-2.25DN	16	20	36	50	92	XCMT080304	M3.0*8			T10

U钻 (U-Drill)

多功能刀杆 浅孔钻/U钻 3.25D Multi fanchon U-drill 3.25D

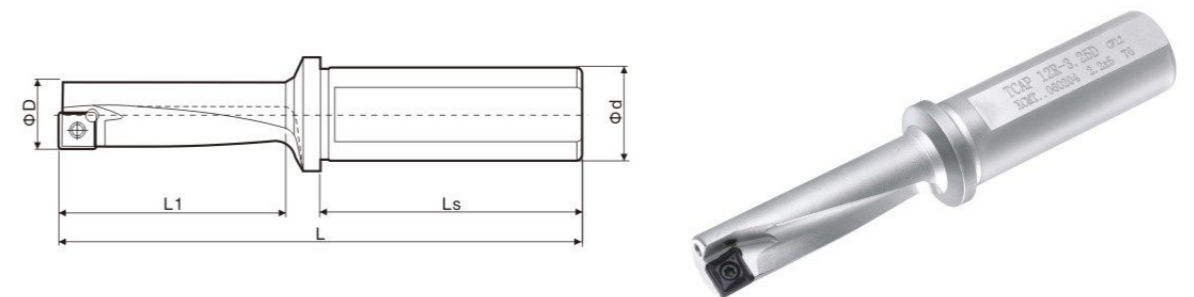

规格型号 Specification and model	D	d	L1	Ls	L	刀片型号 Insert model	螺钉 Screw	扳手 Wrench	库存 Stock	
TCAP 08R/L-3.25DN	8	12	26	42	76	XCMT040104	M1.8*4	T6		
TCAP 10R/L-3.25DN	10		32.5		80	XCMT050204	M2.0*5			
TCAP 12R/L-3.25DN	12	16	39	45	90	XCMT060204	M2.2*5			
TCAP 14R/L-3.25DN	14		45.5		97	XCMT070304	M2.5*6			
TCAP 16R/L-3.25DN	16	20	52	50	108	XCMT080304	M3.0*8			T10

U钻 (U-Drill)

多功能刀杆 浅孔钻/U钻 2.5D Multi function U-drill 2.5D

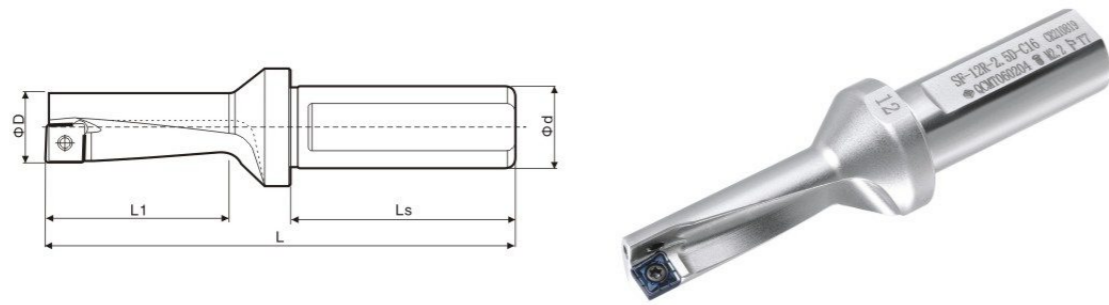

规格型号 Specification and model	D	d	L1	Ls	L	刀片型号 Insert model	螺钉 Screw	扳手 Wrench	库存 Stock
SF-08R-2.5D-C16	8	16	20	42	72	QCMT040104	M1.8*4	T6	
SF-10R-2.5D-C16	10		25		78	QCMT050204	M2.0*5		
SF-12R-2.5D-C16	12		30	87	QCMT060204	M2.2*5			
SF-14R-2.5D-C16	14		35	92	QCMT070304	M2.5*6			
SF-16R-2.5D-C20	16		40	50	102	QCMT080304	M3.0*8		

U钻 (U-Drill)

多功能刀杆 浅孔钻/U钻 3.5D Multi function U-drill 3.5D

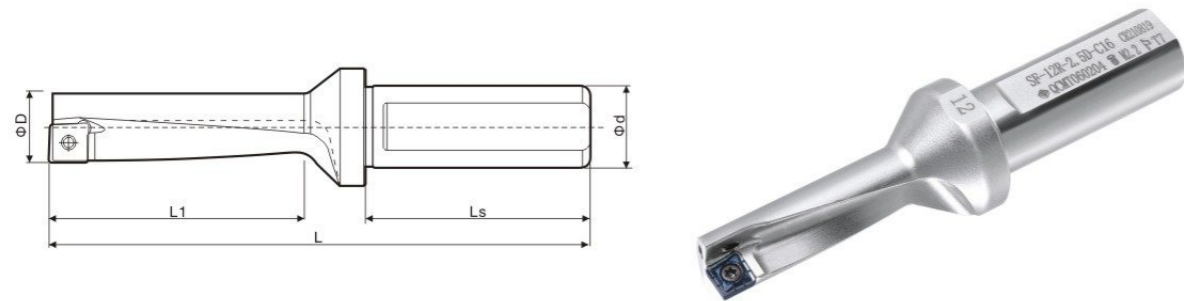

规格型号 Specification and model	D	d	L1	Ls	L	刀片型号 Insert model	螺钉 Screw	扳手 Wrench	库存 Stock
SF-08R-3.5D-C16	8	16	28	42	80	QCMT040104	M1.8*4	T6	
SF-10R-3.5D-C16	10		35		88	QCMT050204	M2.0*5		
SF-12R-3.5D-C16	12		42	98	QCMT060204	M2.2*5			
SF-14R-3.5D-C16	14		49	106	QCMT070304	M2.5*6	T8		
SF-16R-3.5D-C20	16		56	50	118	QCMT080304	M3.0*8		

U钻 (U-Drill)

WC型浅孔钻/U钻 小孔径 WC type U-drill Small Diameter

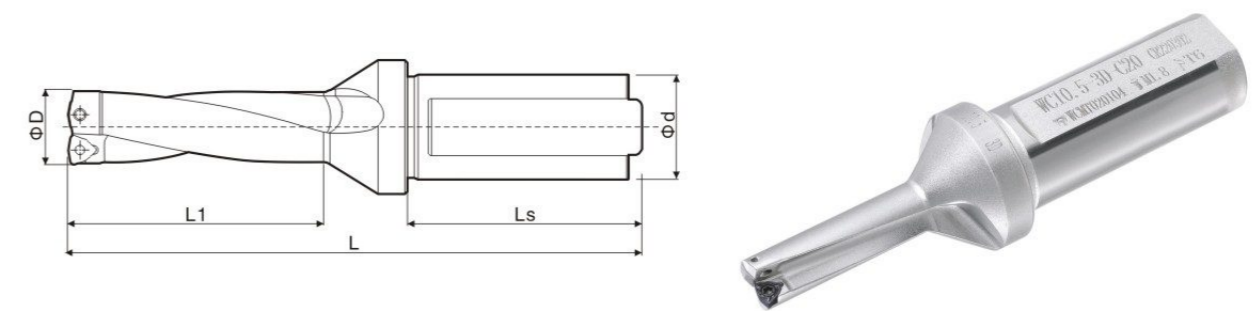

规格型号 Specification and model	D	d	L1	Ls	L	刀片型号 Insert model	螺钉 Screw	扳手 Wrench	库存 Stock
C20-2D10-22WC02	10	20	22	50	90	WC__020104	M1.8*4	T6	
C20-2D10.5-23WC02	10.5		23		91				
C20-2D11-24WC02	11		24		92				
C20-2D11.5-25WC02	11.5		25		93				
C20-2D12-26WC02	12		26		94				
C20-2D12.5-27WC02	12.5		27		95				
C20-2D13-28WC02	13		28						
C20-2D13.5-29WC02	13.5		29		96				

规格型号 Specification and model	D	d	L1	Ls	L	刀片型号 Insert model	螺钉 Screw	扳手 Wrench	库存 Stock
C20-3D10-32WC02	10	20	32	50	101	WC__020104	M1.8*4	T6	
C20-3D10.5-34WC02	10.5		34		103				
C20-3D11-35WC02	11		35		104				
C20-3D11.5-37WC02	11.5		37		106				
C20-3D12-38WC02	12		38		107				
C20-3D12.5-40WC02	12.5		40		109				
C20-3D13-41WC02	13		41		110				
C20-3D13.5-43WC02	13.5		43		112				

规格型号 Specification and model	D	d	L1	Ls	L	刀片型号 Insert model	螺钉 Screw	扳手 Wrench	库存 Stock
C20-4D10-42WC02	10	20	42	50	111	WC__020104	M1.8*4	T6	
C20-4D10.5-44WC02	10.5		44		113				
C20-4D11-46WC02	11		46		115				
C20-4D11.5-48WC02	11.5		48		117				
C20-4D12-50WC02	12		50		119				
C20-4D12.5-52WC02	12.5		52		121				
C20-4D13-54WC02	13		54		123				
C20-4D13.5-56WC02	13.5		56		125				

U钻 (U-Drill)

SO型浅孔钻/U钻 小孔径 SO tyge U-drill Small Diameter

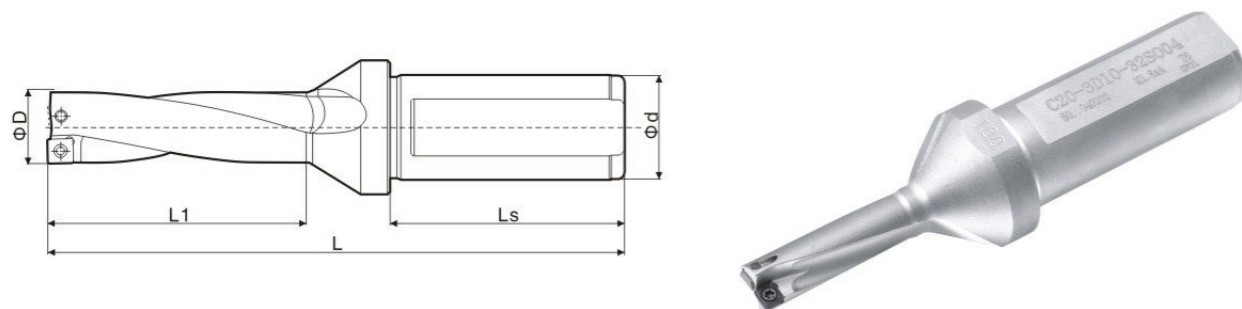

规格型号 Specification and model	D	d	L1	Ls	L	刀片型号 Insert model	螺钉 Screw	扳手 Wrench	库存 Stock
C20-2D10-22SO04	10	20	22	50	91	SO__040102	M1.8*4	T6	
C20-2D10.5-23SO04	10.5		23		92				
C20-2D11-24SO04	11		24		93				
C20-2D11.5-25SO04	11.5		25		94				
C20-2D12-26SO04	12		26		95				

规格型号 Specification and model	D	d	L1	Ls	L	刀片型号 Insert model	螺钉 Screw	扳手 Wrench	库存 Stock
C20-3D10-32SO04	10	20	32	50	101	SO__040102	M1.8*4	T6	
C20-3D10.5-34SO04	10.5		34		103				
C20-3D11-35SO04	11		35		104				
C20-3D11.5-37SO04	11.5		37		106				
C20-3D12-38SO04	12		38		107				

规格型号 Specification and model	D	d	L1	Ls	L	刀片型号 Insert model	螺钉 Screw	扳手 Wrench	库存 Stock
C20-4D10-42SO04	10	20	42	50	111	SO__040102	M1.8*4	T6	
C20-4D10.5-44SO04	10.5		44		113				
C20-4D11-46SO04	11		46		115				
C20-4D11.5-48SO04	11.5		48		117				
C20-4D12-50SO04	12		50		119				

U钻 (U-Drill)

带定心钻头 深孔钻 5D Spotting U-drill 5D

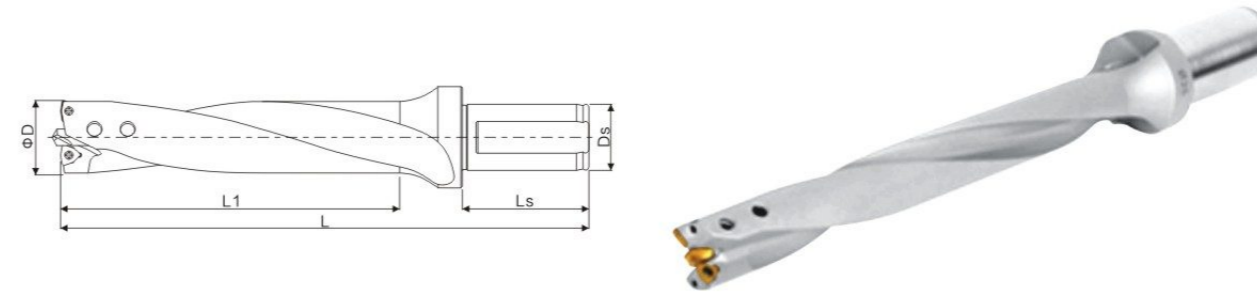

规格型号 Specification and model	D	L1	L	Ds	Ls	刀片型号 Insert model	螺钉 Screw	扳手 Wrench	库存 Stock
VLT-21050D S25	21	105	186	25	56	WCMX030208	M2.5*6	T8	
VLT-22050D S25	22	110	191						
VLT-23050D S25	23	115	196						
VLT-24050D S25	24	120	201						
VLT-25050D S32	25	150	240						
VLT-26050D S32	26								
VLT-27050D S32	27								
VLT-28050D S32	28								
VLT-29050D S32	29								
VLT-30050D S32	30	175	265	WCMX050308	M3.0*8	T10			
VLT-31050D S32	31								
VLT-32050D S32	32								
VLT-33050D S32	33								
VLT-34050D S32	34								
VLT-35050D S32	35	200	290						
VLT-36050D S32	36								
VLT-37050D S32	37								
VLT-38050D S32	38								
VLT-39050D S32	39								
VLT-40050D S32	40								

U钻 (U-Drill)

带定心钻头 深孔钻 6.5D Spotting U-drill 6.5D

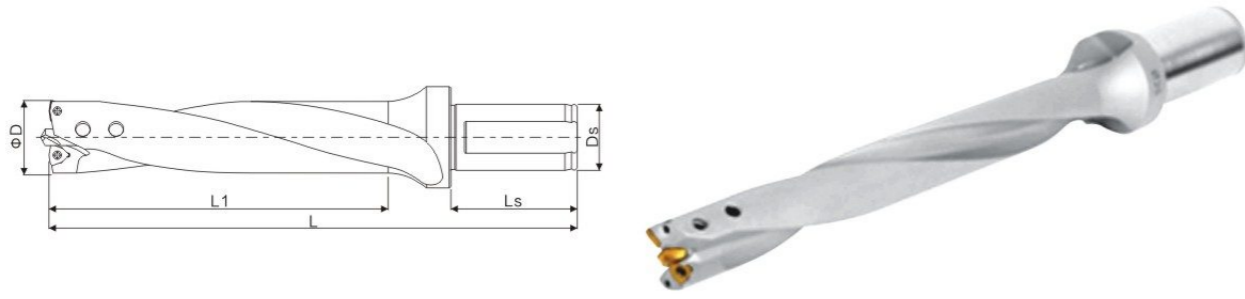

规格型号 Specification and model	D	L1	L	Ds	Ls	刀片型号 Insert model	螺钉 Screw	扳手 Wrench	库存 Stock
VLT-210650D S25	21	137	218	25	56	WCMX030208	M2.5*6	T8	
VLT-220650D S25	22	143	224						
VLT-230650D S25	23	150	231						
VLT-240650D S25	24	156	237						
VLT-250650D S32	25	185	275	32	60	WCMX040208	M2.5*7D4	T8	
VLT-260650D S32	26								
VLT-270650D S32	27								
VLT-280650D S32	28								
VLT-290650D S32	29								
VLT-300650D S32	30								
VLT-310650D S32	31	218	308	32	60	WCMX050308	M3.0*8	T10	
VLT-320650D S32	32								
VLT-330650D S32	33								
VLT-340650D S32	34								
VLT-350650D S32	35	250	340	32	60	WCMX050308	M3.0*8	T10	
VLT-360650D S32	36								
VLT-370650D S32	37								
VLT-380650D S32	38								
VLT-390650D S32	39								
VLT-400650D S32	40								

U钻 (U-Drill)

带定心钻头 深孔钻 8D Spotting U-drill 8D

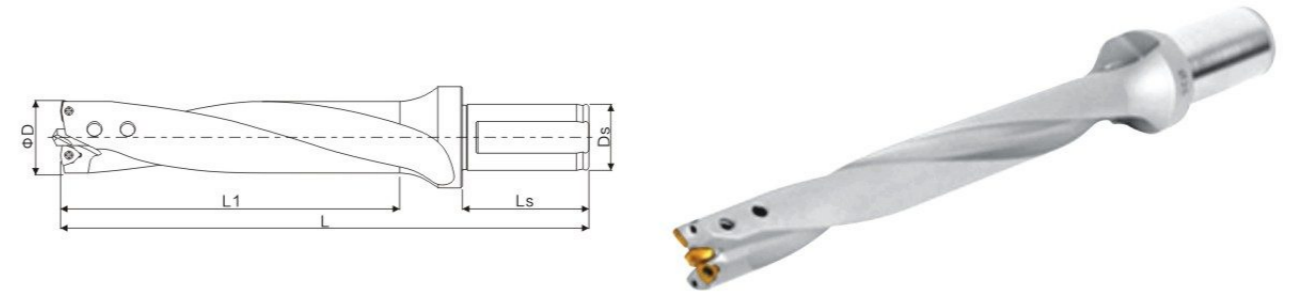

规格型号 Specification and model	D	L1	L	Ds	Ls	刀片型号 Insert model	螺钉 Screw	扳手 Wrench	库存 Stock
VLT-21080D S25	21	168	247	25	56	WCMX030208	M2.5*6	T8	
VLT-22080D S25	22	176	255						
VLT-23080D S25	23	184	263						
VLT-24080D S25	24	192	271						
VLT-25080D S32	25	220	310	32	60	WCMX040208	M2.5*7D4	T8	
VLT-26080D S32	26								
VLT-27080D S32	27								
VLT-28080D S32	28								
VLT-29080D S32	29								
VLT-30080D S32	30								
VLT-31080D S32	31	260	350	32	60	WCMX050308	M3.0*8	T10	
VLT-32080D S32	32								
VLT-33080D S32	33								
VLT-34080D S32	34								
VLT-35080D S32	35	300	390	32	60	WCMX050308	M3.0*8	T10	
VLT-36080D S32	36								
VLT-37080D S32	37								
VLT-38080D S32	38								
VLT-39080D S32	39								
VLT-40080D S32	40								

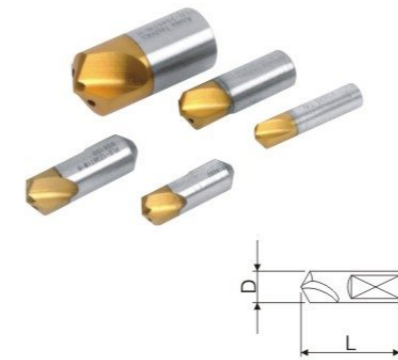

规格型号 Specification and model	D	L	适用钻头类型 Applicable drill bit type
PLD-V0630 TiN	6	30	VLT,TSD,TMD
PLD-V0835 TiN	8	35	VLT,TSD,TMD
PLD-V1035 TiN-H	10	35	VMD,VLT,MXD,TSD,TMD
PLD-V1238 TiN-H	12	38	VMD,VLT,MXD,TSD,TMD
PLD-V1645 TiN-H	16	45	VMD,VLT,MXD,TSD,TMD
PLD-2045 TiN-H	20	45	VMD,MXD
PLD-2556 TiN-H	25	56	VMD,MXD
PLD-3068 TiN-H	30	68	VMD,MXD